



# ENVISION BERKELEY CITY COLLEGE

## *About Berkeley City College's Downtown Berkeley Campus*

Berkeley City College (formerly Vista Community College), the Peralta Community College District, Ratcliff architects and Swinerton Management & Consulting designed a dynamic green building for the college. As it meets the demands of urban education in the 21st century, Berkeley City College continues to offer programs and classes which transfer to U.C. Berkeley, the California State Universities and to private colleges. The college also offers model occupational training programs in American Sign Language, biotechnology, multimedia arts, the sciences, global education, business and information technology.

Two blocks from the University of California, the college's campus is centrally located in downtown Berkeley and provides excellent access to public transportation (BART and AC Transit). It accommodates all of the college's programs, classes and services. As curricula evolve

to meet community needs, the building's flexible design will allow it to grow.

Ground and foundation preparation began in November 2003. Berkeley City College classes and programs moved into their new home at 2050 Center St. in fall 2006. Ratcliff designed the new campus with the goal of achieving a U.S. Green Building Council Leadership in Energy and Environmental Design (LEED) "Certified" rating. The college received a LEED Silver rating in 2007.

*(please turn page)*



### Building Location and Size

Location: 2050 Center Street, Berkeley, CA  
(between Milvia St. & Shattuck Ave.)  
Building area: 165,000 Gross Square Feet

### Building Cost

Design and Construction: \$67,325,000  
Design and Construction Funding: Bond Measures A (1996) & B (1992)  
Bond Measure E (2000)  
Prop. 47 (2002)  
Furniture, Fixtures Equipment: State of California = \$2.1 Million





## Berkeley City College

2050 Center Street • Berkeley, CA 94704 • (510) 981-2800 • [www.peralta.edu](http://www.peralta.edu)

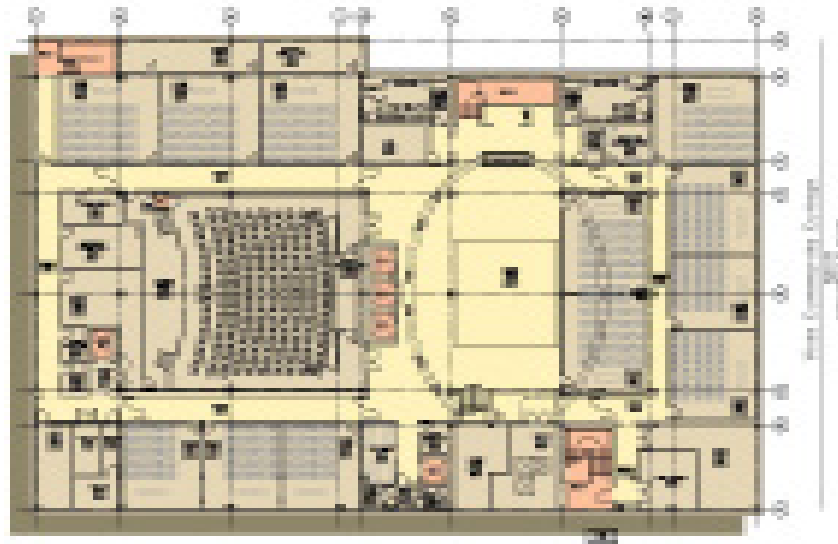

### Six Floors Include—

- The Susan Almon Duncan Library and Jerry L. Adams Learning resources Center.
- A 250-seat ground floor auditorium designed for lectures and multimedia showings with adjacent classrooms that can be used for breakout/meeting rooms.
- A central six-story atrium with a skylight to bring natural light into the building.
- Ground floor cultural space for receptions, exhibits, and community gatherings.
- Twenty-eight classrooms.
- Eleven computer laboratories.
- Laboratories for biology, chemistry, and physical sciences.
- Specialty classrooms with circular seating to accommodate the American Sign Language Program's unique teaching methods.
- A painting and drawing studio.
- A bookstore.
- Student services and counseling offices.
- A student lounge.
- Faculty and administrative offices.
- State-of-the art information and audio-visual technology for the auditorium, classrooms, and labs.
- Modern communications and security infrastructures throughout the building.
- Three high speed computer operated elevators.

